

Fieldstone Bridge

1

Glue the walkway together first.
Set the blocks down on this layout.

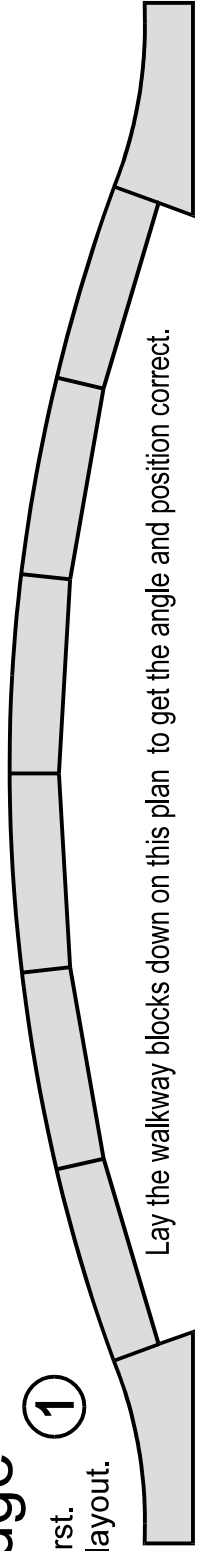

Lay the walkway blocks down on this plan to get the angle and position correct.

2

Make 3 sets of these walkways and glue them together.

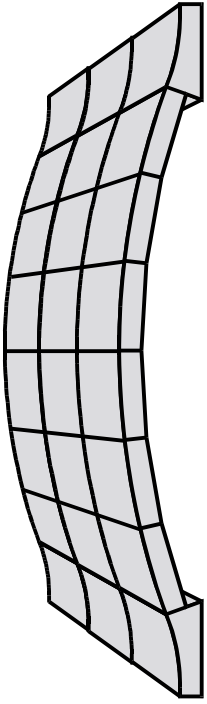

3

Glue together the pieces shown to make one side of the bridge.
Make 2 of these sides.

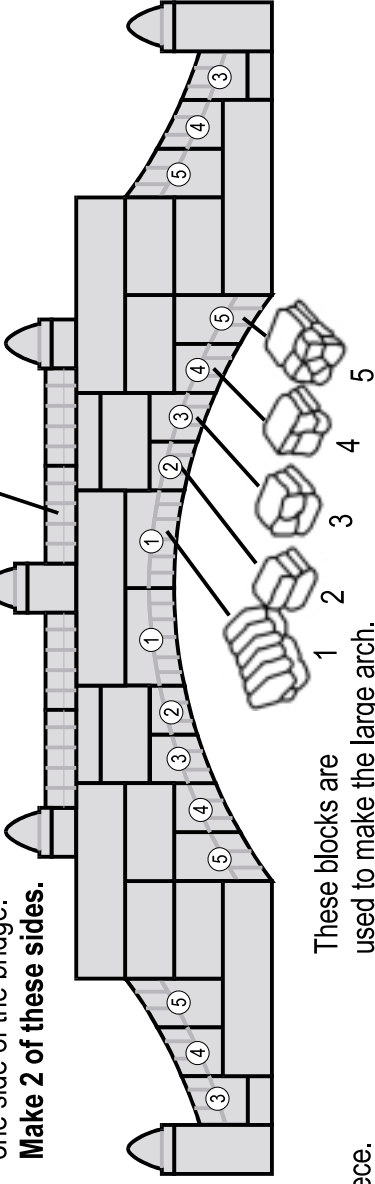

These blocks are used to make the large arch.

The number of stones on the back of blocks 2-5 relate to their position on the arch.

4

Add the columns and faces onto one side of each bridge piece.

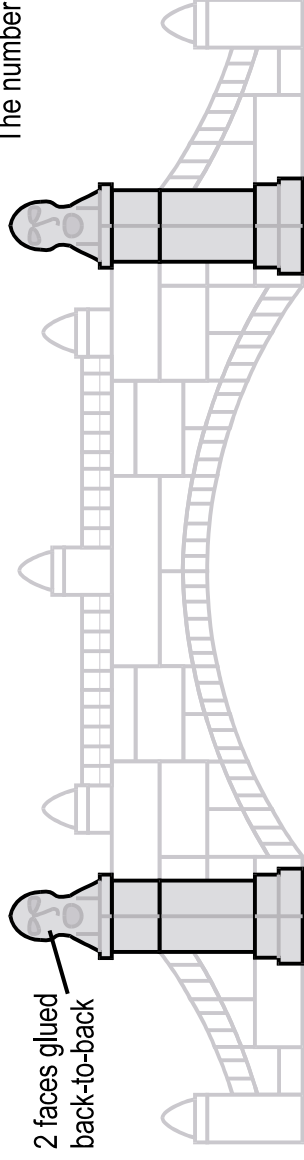

5

For the steps of the bridge, put together 3 step blocks and glue 3 column supports on the back.

Glue 3 flat tiles on top of these to complete the steps.

Make 2 of these step sections.

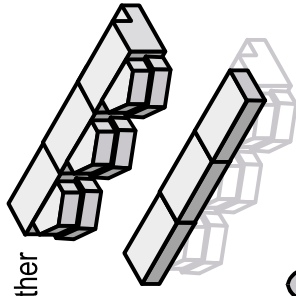

6

Glue the step sections under each end of the walkway.

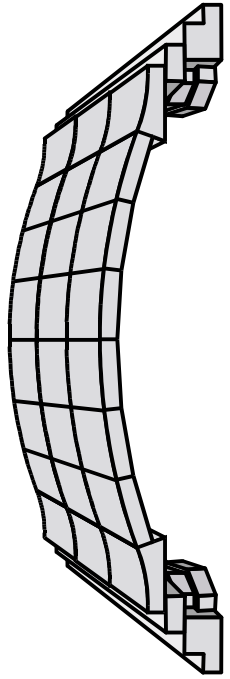

7

Finish the model by gluing the walkway between the 2 sides of the bridge.

